

Wall Mount Uprite *assembly instructions*

Copyright © 2018 DGS Retail
(800) 211-9646 Press 1

Rev Date:
6/20/19

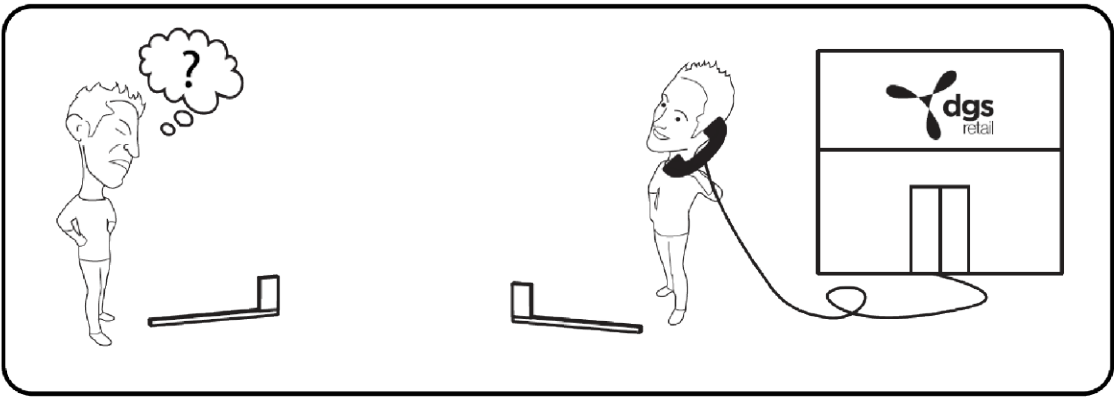
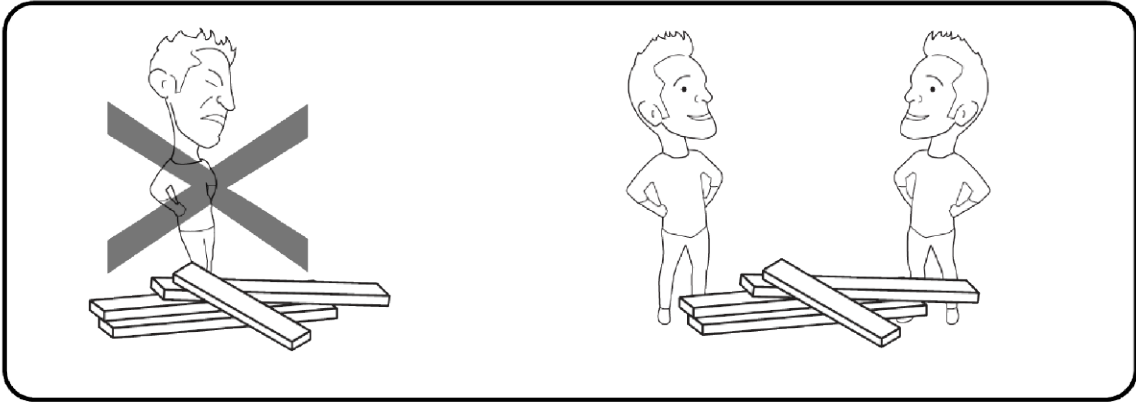
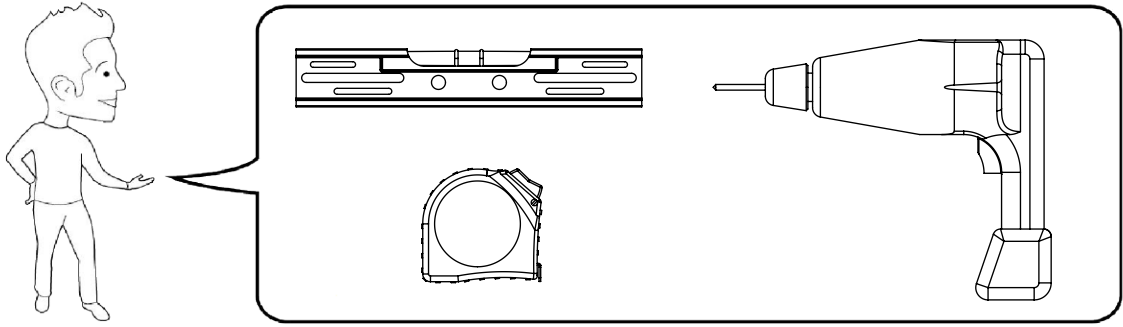

READ BEFORE ASSEMBLING OR USING SHELVING

This basic instruction sheet is supplied by DGS Retail as a reference guide only. Please read complete Lozier Assembly Instructions that can be found online at:

http://www.lozier.com/wp-content/uploads/InstallationInstructions/Basic_Shelving.pdf

- The purchaser of the fixture is responsible for determining the suitability of any specific wall or structure to which the shelving is anchored, for the selection of and/or proper installation of the anchoring fasteners, hardware and materials, and for the workmanship of those performing anchoring. The guidelines are meant to illustrate specific anchoring application. Each application will vary due to the building structure and materials used for anchoring, and professional advice should be sought for each anchoring installation.
- The online Lozier assembly instructions and safety information should be reviewed with all store personnel, and along with all other instructions for Lozier products, must be preserved and provided to any subsequent user or purchaser of these fixtures. Additional copies available upon request.
- Install all shelving according to installation instructions and use components only as instructed. Shelving and components should only be installed or rearranged by trained personnel who have read and understand these instructions and warnings.
- Anchoring situations other than those illustrated may be encountered. As a guideline, each anchoring location shown must provide a minimum of 450 pounds of pull-out resistance and be located as shown in these illustrations. Extreme care must be taken to insure that the building wall or other structure is solid and suitable for anchoring and will support the load being anchored to it.
- Local codes and regulations concerning building, fire, sanitation, or seismic requirements may apply to some installations. It is the responsibility of the owner of these fixtures to check with local building authorities to determine what codes or regulations, if any, apply and always install the shelving in compliance with any such requirements.
- When installing or rearranging shelving, never move assembled shelving.
- Do not combine Lozier products with non-Lozier products.
- Never use damaged parts. Damaged parts may cause shelving to be structurally unsafe or create exposure to sharp or pointed edges. If parts were damaged in shipment, do not use and contact your Lozier Customer Service Representative. If parts are damaged after shipment, discontinue use immediately and order replacement parts.
- Shelving (or racks) that are leaning or bending when loaded may indicate a dangerous overload or impending collapse.
- Loads should be immediately reduced, and the cause for this condition should be corrected, before reloading. Refer to appropriate installation instructions to assure shelving (or racks) are properly assembled, replace any damaged components or parts, and do not exceed recommended maximum loads or engage in any other unsafe use of the shelving (racks).
- Provide safe access to all levels of storage & display shelving in accordance with applicable OSHA regulations. Never allow anyone to climb, walk, or stand on shelving. These shelves were not designed to withstand the extra weight and impact of climbing, walking and standing, and the added weight and impact of such actions may cause the fixture to collapse.
- Never alter, modify or otherwise structurally change the shelving or any of its component parts. Modification or alteration may cause the shelving or component part to become structurally unsafe resulting in tipping, collapse or other failure of the fixture.



**DO NOT USE PLASTIC OR FIBER ANCHORS,
CONCRETE NAILS, OR REGULAR NAILS.**

- Warning: The lowest shelf must be at or below 27" (685mm) above the finished floor or a cane detectable barrier must be used below the shelves to keep individuals from contacting shelves that protrude into aisles.

1

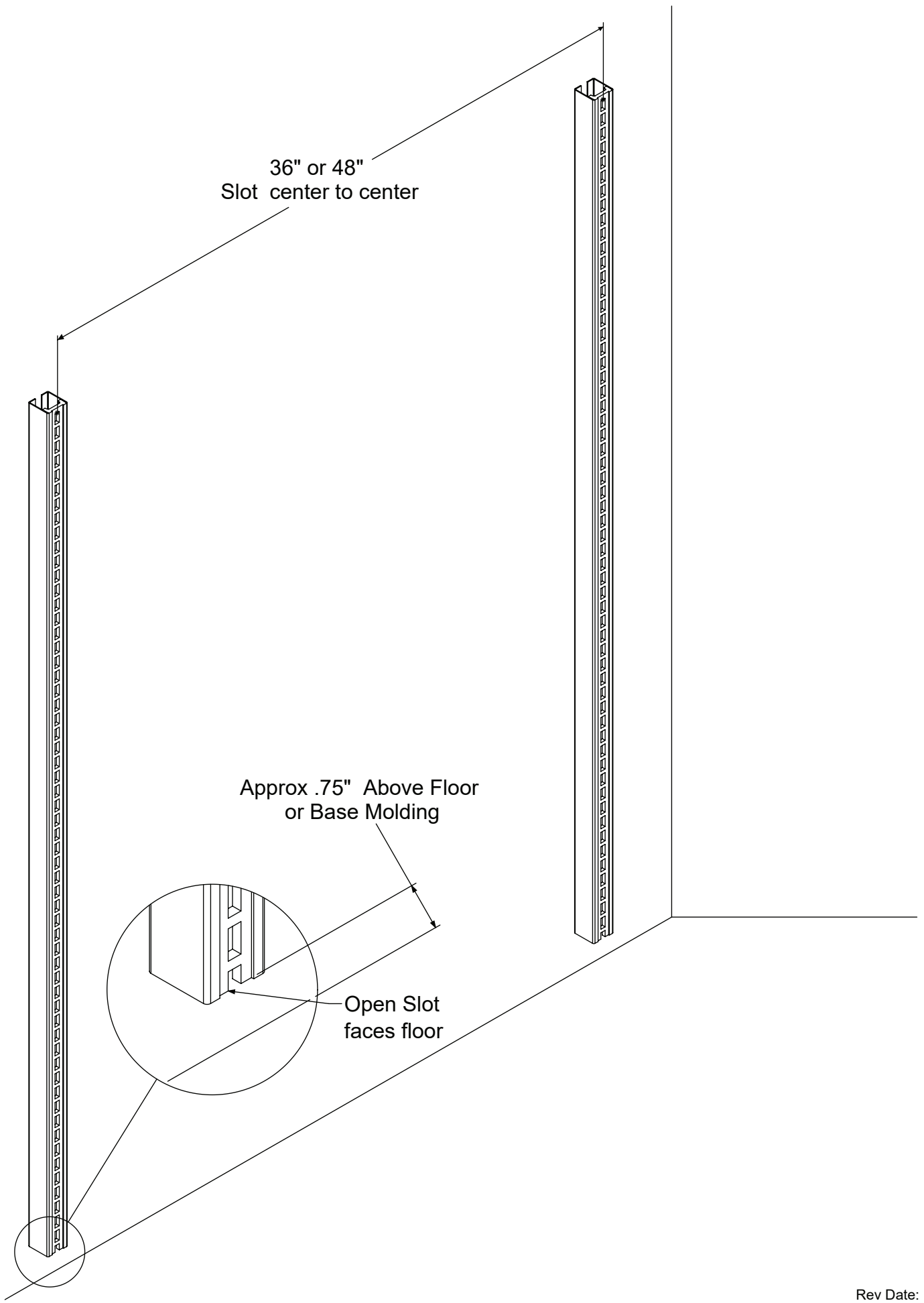

2

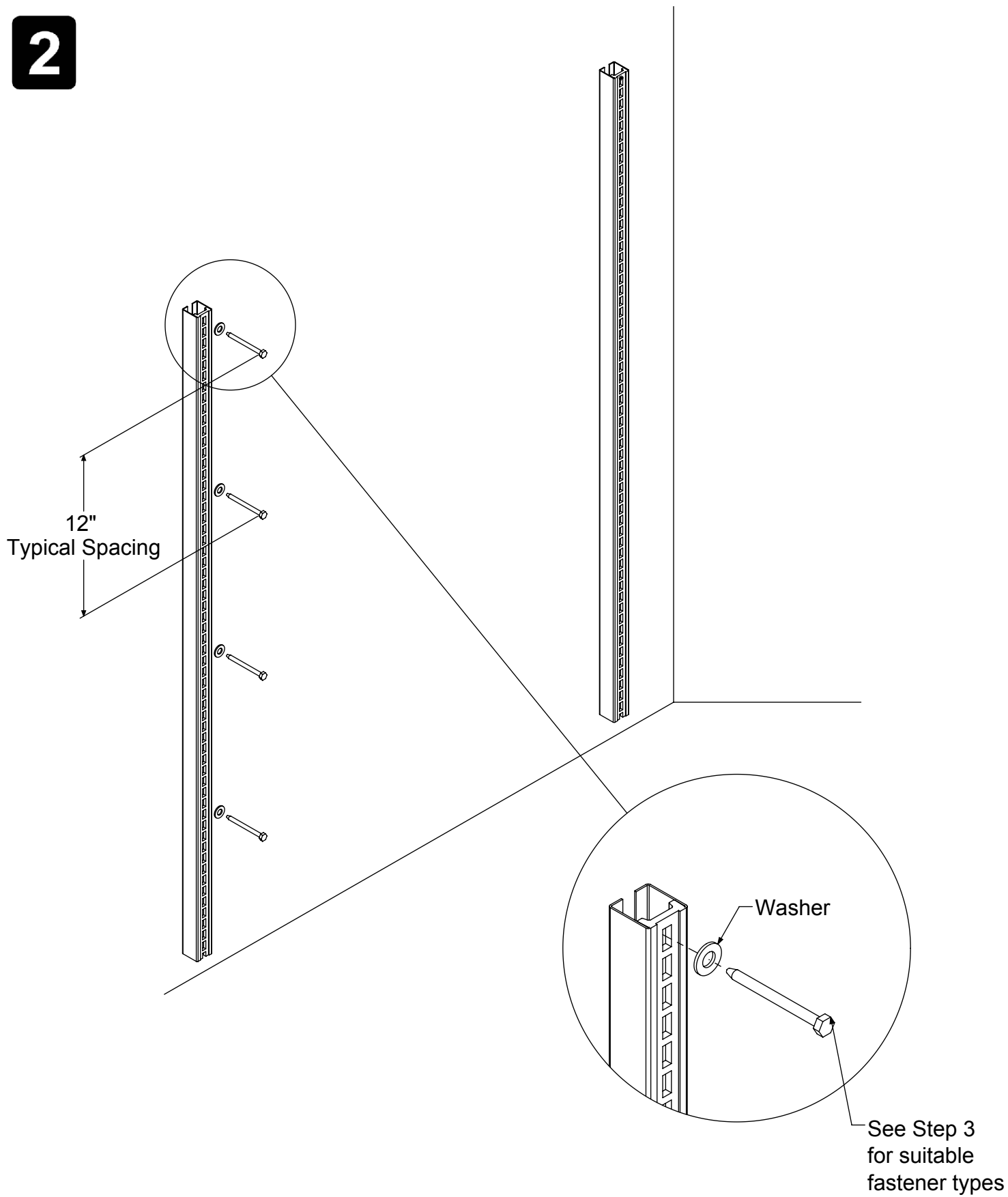

3

Attaching Upright Directly to Wall

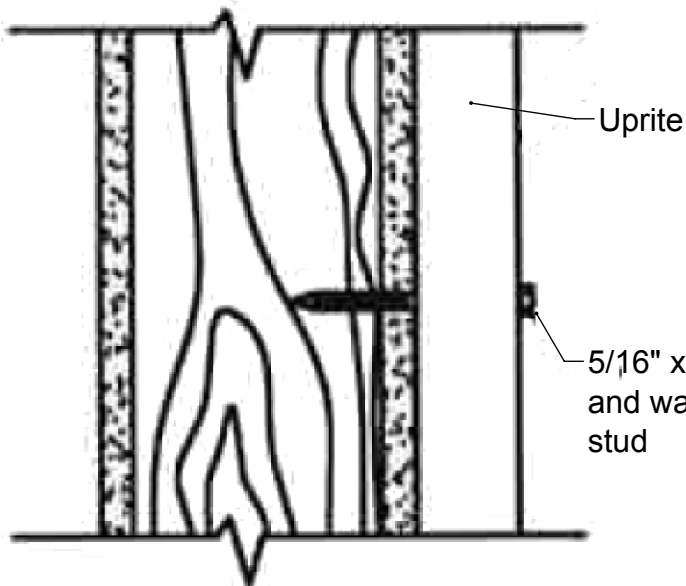

Wood Stud Wall

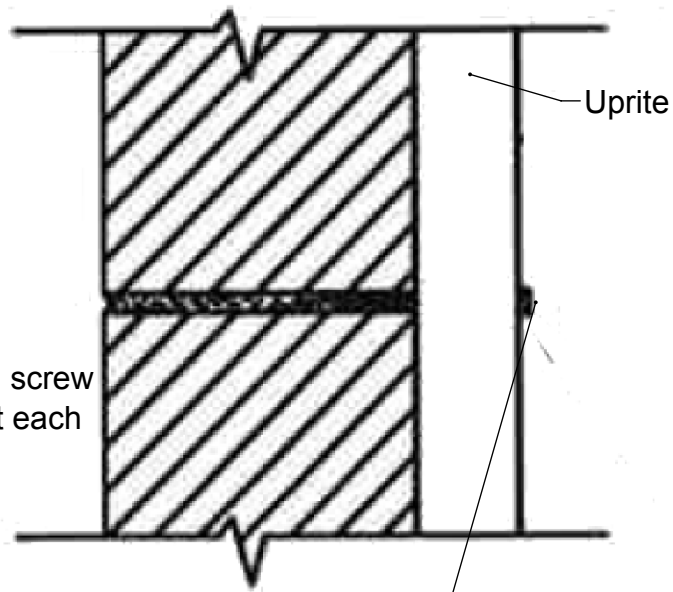

Masonry Wall

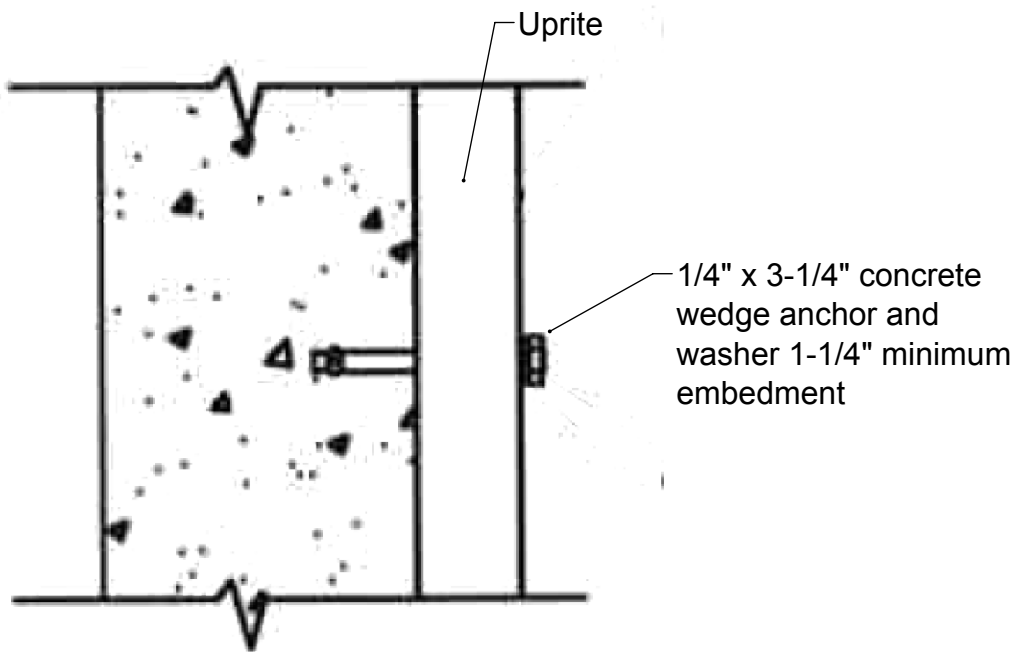

Concrete Wall

4

Attaching Blocking to Wall

Attach as near as possible to uprite

12" TYP

5/16" x 2-3/4" Lag Screw and washer through uprite into blocking

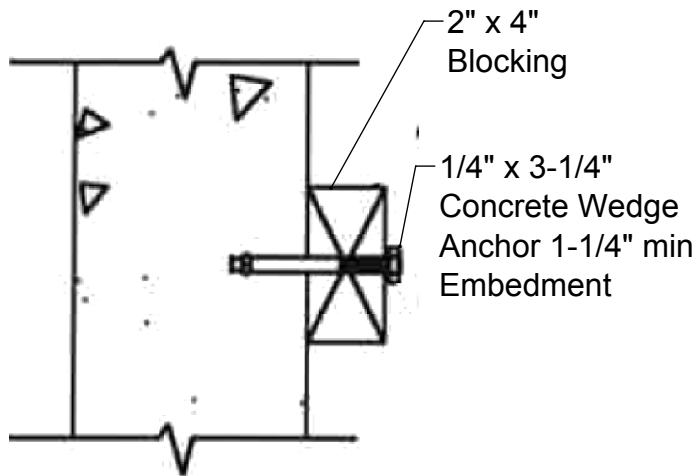

Concrete

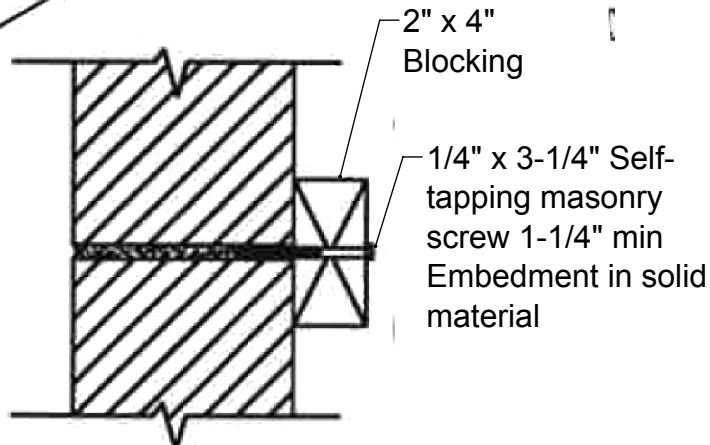

Masonry

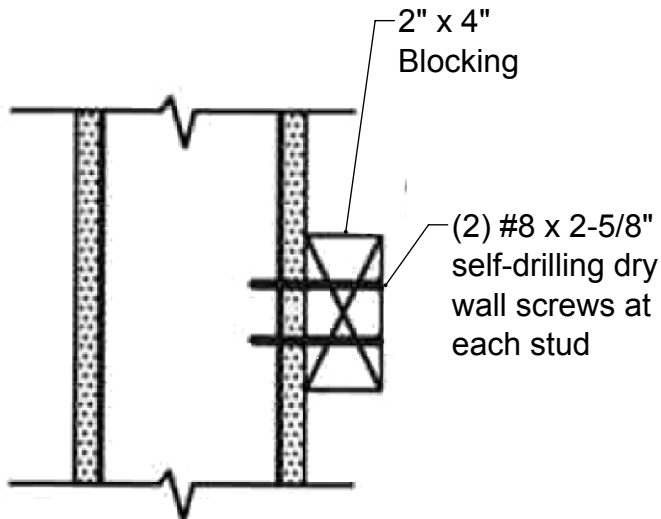

Metal Stud Wall

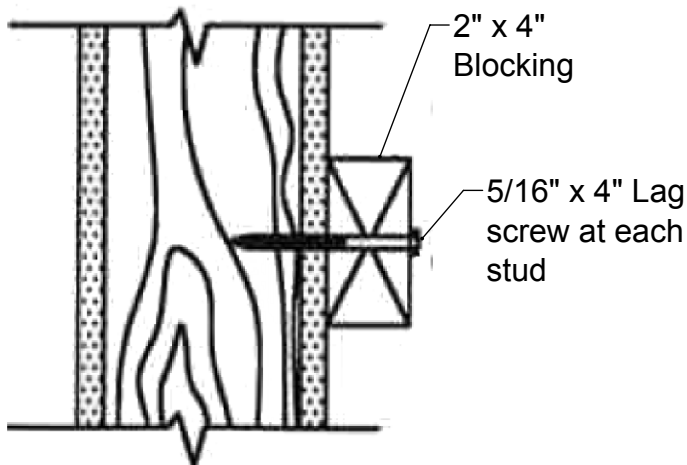

Wood Stud Wall